

TECHNICAL DATA SHEET



Phone: 516.294.1801
 Fax: 516.294.1828
 350 Thorens Avenue
 Garden City Park, NY 11040
 www.metropolitandoor.com

MODEL PHS HIGH SECURITY DOOR

INSTALLATION (CEILING ONLY)

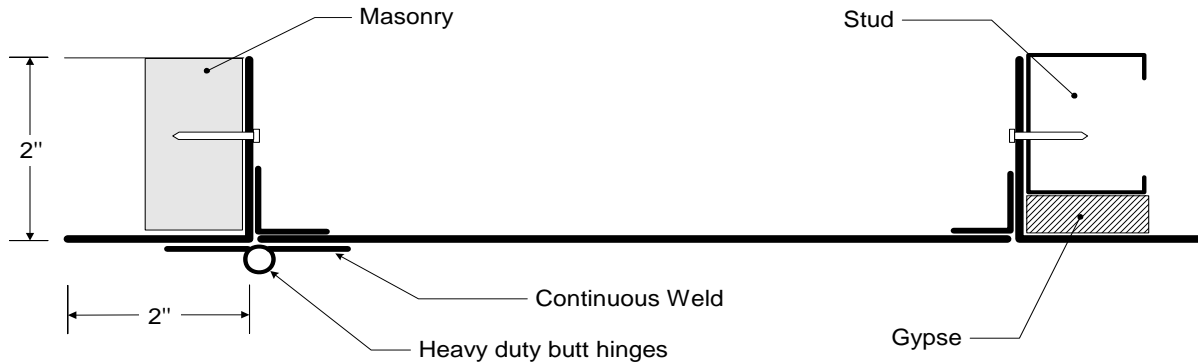

DIMENSION AND APPEARANCE

DOOR SIZE W x H (IN)	OPENING (IN)	NUMBER OF LOCKS	SHIP WEIGHT (LBS) (KG)	
12 x 12	12 1/2 x 12 1/2	1	13.2	6
16 x 16	16 1/2 x 16 1/2	1	18.9	8.6
18 x 18	18 1/2 x 18 1/2	1	22	10
24 x 24	24 1/2 x 24 1/2	1	34	15.5
24 x 30	24 1/2 x 30 1/2	2	48.4	22
24 x 36	24 1/2 x 36 1/2	2	61.6	28
36 x 36	36 1/2 x 36 1/2	2	88	40

(Special sizes available upon request)

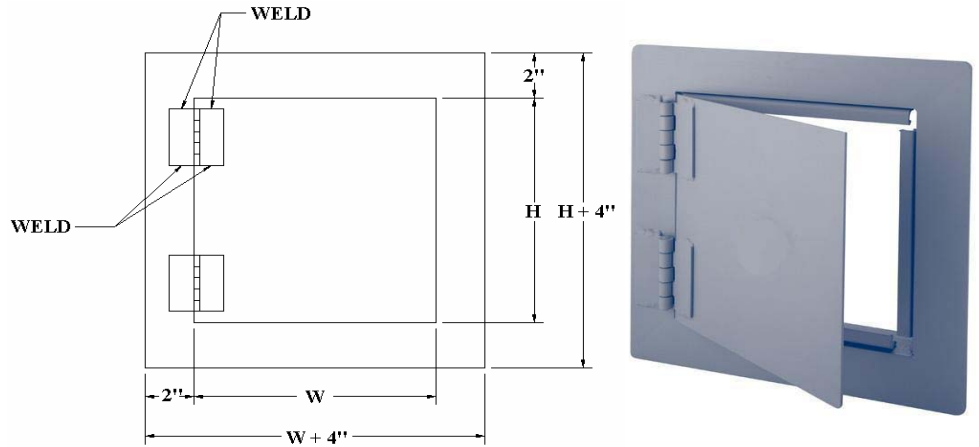

DESCRIPTION AND MATERIAL SPECIFICATION

Material : 10 gauge steel plate
 2" x 2" x 3/16" angle frame
Hinge : 3" x 3" heavy duty butt hinges 13 gauge steel
Lock / latch : as per customer's request
Finish : phosphate dipped steel with Sherwin-Williams high quality grey powder coat primer

Options:
 14 gauge steel
Lock / latch : cylinder lock and key or mortise preparation for cylinder lock (cylinder optional) or detention lock

PROJECT DATA

Project name	Qty	W	H	# of locks	Finish
Architect :					
Dealer :					
Contractor :					
Location :					
Date :	Special instructions :				
Tagging Instructions :					

CUSTOMER APPROVAL: _____ **DATE:** _____