

# TECHNICAL DATA SHEET



Phone: 516.294.1801  
 Fax: 516.294.1828  
 350 Thorens Avenue  
 Garden City Park, NY 11040  
 www.metropolitandoor.com

## MODEL PFU-GYP UPWARD SWINGING FIRE RATED INSULATED ACCESS DOOR W/ DRYWALL BEAD

### INSTALLATION (CEILING ONLY)

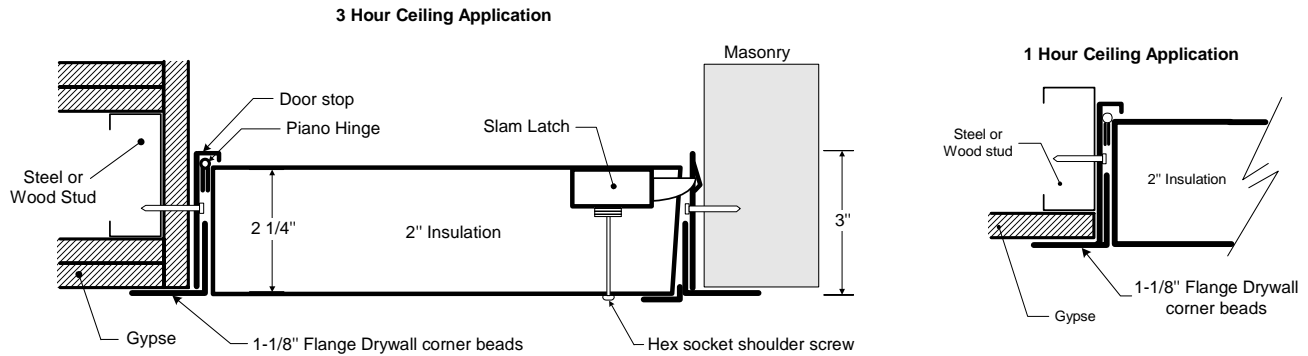

### DIMENSION AND APPEARANCE

DOOR SIZE W x H (IN)	CEILING OPENING (IN)	NUMBER OF LOCKS	SHIP WEIGHT	
			(LBS)	(KG)
22 x 30	22 3/8 x 30 1/4	1	44	20
22 x 36	22 3/8 x 36 1/4	2	50.5	23
24 x 24	24 3/8 x 24 1/4	1	37.5	17

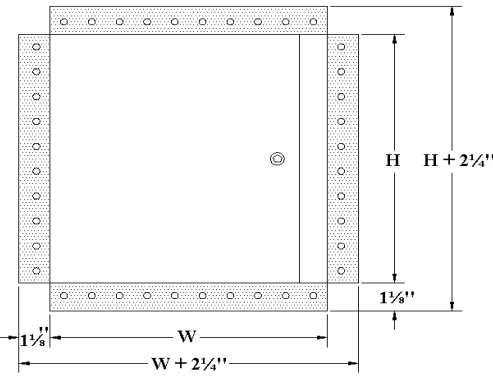

(Clear opening with door opened =  $W - 3 \frac{1}{2}''$ )

**Max. size to maintain fire rating: 24" x 36".**

### DESCRIPTION AND MATERIAL SPECIFICATION

**Fire Rating :** 2 hour fire barrier, 1 1/2 hour B label, maximum temperature rise after 30 minutes 250° F (139° C) after 60 minutes 450° F (250° C) Warnock Hersey file #: L-14031 for ceiling one (1) hour combustible rating and three (3) hour non-combustible rating in conformance with the following codes: UBC 43-7 for ceiling installation MEA# 507-06-M

**Material :** satin coated steel : 16 gauge frame and 20 gauge door

**Insulation :** mineral wool  
**Hinge :** continuous piano hinge allows opening to 89°  
**Lock / latch :** self latching ring operated latch inside and allen key operated outside phosphate dipped steel with high quality Sherwin-Williams grey powder coat primer wrapped individually in a box  
**Options:**  
**Material :** stainless steel 304 #4 (brushed finish)



### PROJECT DATA

Project name	Qty	W	H	# of locks	Finish
Architect :					
Dealer :					
Contractor :					
Location :					
Date :	Special instructions :				
Tagging Instructions :					

CUSTOMER APPROVAL:

DATE: